

MAG. NORTH

N 7°15' W 124.0'

ONEAL ROAD

S 82°45' W 25.0'

S 7°15' E 60.0'

33 A

33

33 B

This is to certify that on December 30, 1976, I surveyed the property shown on this plat, known as Lot 33 on Plat of Morgan Hill, recorded in the RMC Office of Greenville County in Plat Book A on Page 69, and that the property lines, walls and buildings are as shown hereon; that the building located on said lot does not encroach or project on adjacent streets or property, and that no adjacent walls or buildings encroach or project on said premises, and that no utility lines cross this property except as shown hereon.

James R. Freeland
James R. Freeland RLS&PE 4781

TELEPHONE

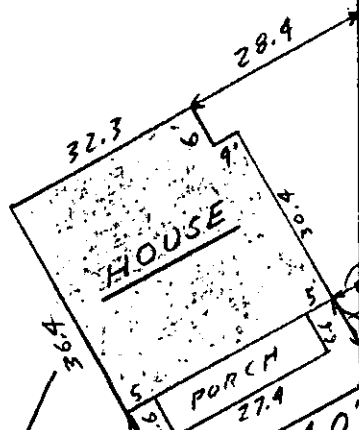
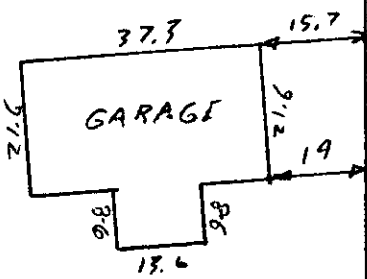

FILED
GREENVILLE CO. S.C.
JAN 4 4 33 PM '77
DONNIE S. TARKERSLEY
R.M.C.

S 82°28' N 165.4'

MONAGHAN ROAD
S 37°00' E 74.0'

POWER

JAN 4 '77

✓ 5Z-63

17846

MICROFILMED

1 P'S @ ALL CORNERS

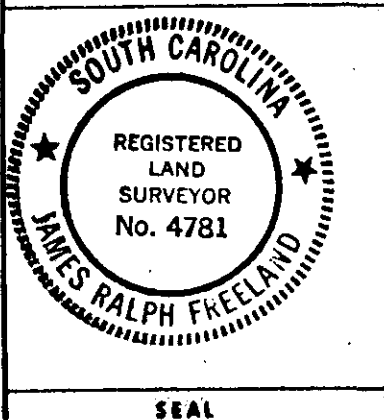

**STATE OF SOUTH CAROLINA
GREENVILLE COUNTY**

MORGAN - HILL

LOT 33

PROPERTY OF

WILTON L. DAVENPORT JR

MARY J. DAVENPORT

FREELAND & ASSOCIATES
Engineers • Land Surveyors

GREENVILLE, S. C.

SURVEY	BH
DRAWN	JRF
CHECK	ML
SCALE	1" = 30'
DATE	12-30-76
DWG. NO.	76-1314